

BRADYPRINTER™ Bench-top THT Models



BP-PRECISION, BRADYPRINTER™ MODELS 200MVP, 300MVP AND 600X-PLUS II

These printers excel at higher volume print jobs. Featuring print resolutions of 203, 300 and 600 dpi and print widths up to 104 mm, Brady's printers are ideal for slide, well plate and vial identification. Use with BradySoft™ software (sold separately on p. 22).

- PC-connected operation only
- Highest resolution printing (up to 600 dots per inch depending on model)
- Fastest print speeds
- Recommended for printing > 1000 labels at a time



Order Reference	Description
BP Precision	
BP-PR300PLUS	BRADYPRINTER™ Precision Printer 300 dpi
BP-PR300PLUS-P	BRADYPRINTER™ Precision Printer 300 dpi + Peel Off Unit
BP-PR600PLUS	BRADYPRINTER™ Precision Printer 600 dpi
BP-PR600PLUS-P	BRADYPRINTER™ Precision Printer 600 dpi + Peel Off Unit
Model 200MVP	
BP-THT-200MVP-PLUS	BRADYPRINTER™ THT Model 200MVP
BP-THT-200MVP-PLUS-R	BRADYPRINTER™ THT Model 200MVP with Internal Rewind
Model 300MVP	
BP-THT-300MVP-PLUS	BRADYPRINTER™ THT Model 300MVP
BP-THT-300MVP-PLUS-R	BRADYPRINTER™ THT Model 300MVP with Internal Rewind
Model 600X-Plus II	
BPT-THT-600X-II	BRADYPRINTER™ THT Model 600X-Plus II
BPT-THT-600X-II-R	BRADYPRINTER™ THT Model 600X-Plus II with Internal Rewind
BPT-THT-600X-II-C	BRADYPRINTER™ THT Model 600X-Plus II with Cutter



Ribbon Selection Guide for Benchtop THT Printers

Match your material with the appropriate ribbon.

Brady Material Number	Material	Series 4300	Series 4400 (Colours)	Series 4500	Series 4900	Series 6600	Series 6200
B-351	Vinyl	▲●					
B-423	Polyester		●●▲				
B-424	Paper	●					
B-427	Vinyl	●▲					
B-430	Polyester		●●▲				
B-449	Polypropylene						●
B-461	Polyester	●▲					
B-488	Polyester	●					
B-490	Polyester	●					
B-492	Polyester			●			
B-498	Vinyl Cloth	▲●					
B-499	Nylon Cloth	●●▲					

- Recommended ribbon for use with respective material
- ▲ Acceptable ribbon for use with respective material

BRADYPRINTER™ Bench-top THT Labels

- F** Freezer environment
- N** Liquid nitrogen environment
- A** Autoclave environment
- H** Hot water (100°C) bath
- S** Self-laminating label
- L** Low-profile (extremely thin) label
- R** Removable

- V** Vial identification
- S** Slide identification
- P** Plate identification
- G** General identification

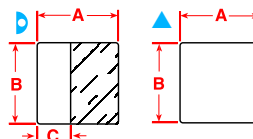

CENTRIFUGE / EPPENDORF / PCR TUBE LABELS

Diagram	Order Reference	Label Width A (mm)	Label Height B (mm)	Write-On Area C (mm)	Labels/Package	BP1344 Model Ribbon	BP Precision™ 200/300MVP 600X-II Ribbon	Special Properties
0.5 TO 0.7 ml TUBE								
▲	THT-68-499-10	19.05	12.70	–	10,000	R-4901	R-4902	FNA V PG
▲	THT-152-499-3	25.40	9.53	–	3,000	R-4301	R-4306	FNAH L V PG
▲	THT-152-492-3	25.4	9.53	–	3,000	R-4300	R-6400	FNAH L V PG
▲	THT-154-490-3	31.75	9.53	–	3,000	R-4301	R-4300	FNAHSL V PG
▷	THT-123-461-3	45.72	9.53	19.05	3,000	R-4301	R-4302	FNAHSL V PG
▷	THT-122-461-3	45.72	12.70	19.05	3,000	R-4301	R-4302	FNAHSL V PG
▷	THT-127-427-3	55.88	12.70	19.05	3,000	R-4301	R-4302	FN S V PG
▷	THT-127-461-3	55.88	12.70	19.05	3,000	R-4301	R-4302	FNAHSL V PG
1.5 TO 2.0 ml TUBE								
▲	THT-59-492-10	25.40	12.70	–	10,000	R-4300	R-6400	FNAH L V PG
▲	THT-126-499-3	22.86	12.70	–	3,000	R-4301	R-4302	FNAH L V PG
▷	THT-133-461-3	41.28	15.24	25.40	3,000	R-4301	R-4302	FNAHSL V PG
▷	THT-155-490-3	41.28	15.24	–	3,000	R-4301	R-4302	FNAH L V PG
▷	THT-127-427-3	55.88	12.70	19.05	3,000	R-4301	R-4302	FN S V PG
▷	THT-127-461-3	55.88	12.70	19.05	3,000	R-4301	R-4302	FNAHSL V PG
▷	THT-153-461-3	66.68	15.24	25.40	3,000	R-4301	R-4302	FNAHSL V PG

VIAL / TUBE LABELS

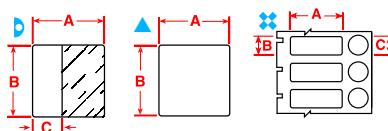
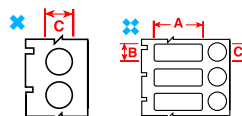

Diagram	Order Reference	Label Width A (mm)	Label Height B (mm)	Write-On Area/ Diameter C (mm)	Labels/Package	BP1344 Model Ribbon	BP Precision™ 200/300MVP 600X-II Ribbon	Special Properties
0.6 ml VIAL / TUBE								
▲	THT-68-499-10	19.05	12.70	–	1,000	R-4901	R-4902	FNA V PG
▲	THT-125-499-3	22.86	12.70	–	3,000	R-4301	R-4306	FNAH L V PG
▷	THT-127-427-3	55.88	12.70	19.05	3,000	R-4301	R-4302	FN S V PG
▷	THT-127-461-3	55.88	12.70	19.05	3,000	R-4301	R-4302	FN S V PG
1.0 TO 8.0 ml VIAL / TUBE								
▲	THT-125-499-3	22.86	12.70	–	3,000	R-4301	R-4306	FNAH L V PG
✳	THT-126-499-3	22.86	12.70	12.70	3,000	R-4301	R-4306	FNAH L V PG
▷	THT-133-461-3	41.28	15.24	25.40	3,000	R-4301	R-4302	FNAHSL V PG
▲	THT-155-490-3	41.28	15.24	–	3,000	R-4301	R-4300	FNAH L V PG
▲	THT-156-490-3	48.26	25.40	–	3,000	R-4301	R-3000	FNAH L V PG
▲	THT-156-492-3	48.26	25.40	–	3,000	R-4300	R-6400	FNAH L V PG
▷	THT-153-461-3	66.68	15.24	25.40	3,000	R-4301	R-4300	FNAHSL V PG
▷	THT-131-427-3	66.68	25.40	25.40	3,000	R-4301	R-4300	FN S V S PG
▷	THT-131-461-3	66.68	25.40	25.40	3,000	R-4301	R-4300	FNAHSL V S PG
12.0 TO 24.0 ml VIAL / TUBE								
▷	THT-134-461-3	88.90	38.10	31.75	3,000	R-4301	R-4307	FNAHSL V PG
▷	THT-139-461-2	133.35	25.40	25.40	2,000	R-4301	R-4306	FNAHSL V PG



VIAL TOP LABELS

Diagram	Order Reference	Label Width A (mm)	Label Height B (mm)	Diameter C (mm)	Labels/Package	BP1344 Model Ribbon	BP Precision™ 200/300MVP 600X-II Ribbon	Special Properties
0.6 TO 1.5 ml VIAL / TUBE								
✳	THT-143-499-3	–	–	9.53	3,000	R-4301	R-4302	FNAH L V PG
✳	THT-143-492-3	–	–	9.53	3,000	R-4300	R-6400	FNAH L V PG
1.0 TO 2.0 ml VIAL / TUBE								
✳	THT-144-499-3	–	–	12.70	3,000	R-4301	R-4302	FNAH L V PG
✳	THT-144-492-3	–	–	12.70	3,000	R-4300	R-6400	FNAH L V PG
✳	THT-126-499-3	22.86	12.70	12.70	3,000	R-4301	R-4302	FNAH L V PG
✳	THT-163-499-3	25.40	9.53	9.53	3,000	R-4301	R-4300	FNAH L V PG
✳	THT-163-492-3	25.40	9.53	9.53	3,000	R-4300	R-6400	FNAH L V PG
✳	THT-181-492-3	25.40	12.70	9.53	3,000	R-4300	R-6400	FNAH L V PG
✳	THT-182-492-3	25.40	12.70	12.18	3,000	R-4300	R-6400	FNAH L V PG

BRADYPRINTER™ Bench-top THT Labels

- F** Freezer environment
- N** Liquid nitrogen environment
- A** Autoclave environment
- H** Hot water (100°C) bath
- S** Self-laminating label
- L** Low-profile (extremely thin) label
- R** Removable

- V** Vial identification
- S** Slide identification
- P** Plate identification
- G** General identification

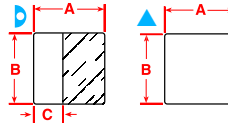

CONICAL / BOTTLE / PETRI-DISH / DEEP WELL PLATE LABELS

Diagram	Order Reference	Label Width A (mm)	Label Height B (mm)	Write-On Area/ C (mm)	Labels/ Package	BP1344 Model Ribbon	BP Precision™ 200/300MVP 600X-II Ribbon	Special Properties
14.0 to 15.0 ml CONICAL TUBE								
	THT-134-461-3	88.90	38.10	31.75	3,000	R-4301	R-4307	F N A H S L V
50.0 ML CONICAL TUBE / BOTTLES / PETRI-DISH / DEEP WELL PLATE								
	THT-17-423-3	50.80	25.40	-	3,000	R-6001	R-6000	F A P G
	THT-41-423-10	25.40	4.75	-	10,000	R-6001	R-6002	F A P G
	THT-51-423-10	25.40	6.35	-	1,000	R-6001	R-6002	F A P G
	THT-5-423-10	25.40	12.70	-	10,000	R-6001	R-6002	F A R P G
	THT-135-427-AW-3**	38.10	19.05	-	3,000	R-4301	R-4306	F N V
	THT-136-499-3	38.10	19.05	-	3,000	R-4301	R-4302	F N A V P G
	THT-137-427-AW-3**	50.80	25.40	-	3,000	R-4301	R-4302	F N V P G
	THT-137-499-3	50.80	25.40	-	3,000	R-4301	R-4302	F N A V P G
	THT-158-490-3	95.25	38.10	-	3,000	R-4301	R-4300	F N A H S L V
	THT-139-461-2	133.35	25.40	38.10	2,000	R-4301	R-4306	F N A H L V P G
	THT-179-492-3	25.40	25.40	-	3,000	R-4300	R-6400	F N A H L
	THT-180-492-3	22.86	25.40	-	3,000	R-4300	R-6400	F N A H L

** AW= All White / no transparent area

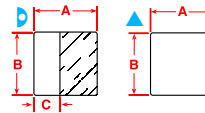

SLIDE LABELS

Diagram	Order Reference	Label Width A (mm)	Label Height B (mm)	Write-On Area/ C (mm)	Labels/ Package	BP1344 Model Ribbon	BP Precision™ 200/300MVP 600X-II Ribbon	Special Properties
	THT-140-488-3	22.86	19.05	-	3,000	R-4301	R-4306	F A S P G
	THT-141-488-3	22.86	22.86	-	3,000	R-4301	R-4306	F A S P G
	THT-164-488-1	22.86	22.86	-	1,000	R-4301	R-4306	F A S P G
	THT-10-427-3	25.40	95.25	25.40	3,000	R-4301	R-4300	F N S V S P G

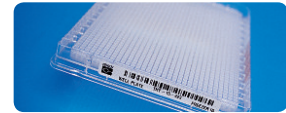
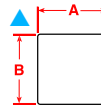

WELL PLATE LABELS

Diagram	Order Reference	Label Width A (mm)	Label Height B (mm)	Write-On Area/ C (mm)	Labels/ Package	BP1344 Model Ribbon	BP Precision™ 200/300MVP 600X-II Ribbon	Special Properties
	THT-15-423-2.5	50.80	6.35	-	2,500	R-6001	R-6000	F A S P G
	THT-151-499-3	50.80	6.35	-	3,000	R-4301	R-4302	F N A V P G
	THT-142-423-2.5	63.50	5.08	-	2,500	R-6001	R-6002	F A S P G

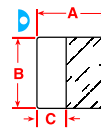

STRAW LABELS

Diagram	Order Reference	Label Width A (mm)	Label Height B (mm)	Write-On Area/ C (mm)	Labels/ Package	BP1344 Model Ribbon	BP Precision™ 200/300MVP 600X-II Ribbon	Special Properties
	THT-116-427-5	25.40	25.40	9.53	5,000	R-4301	R-4302	F N S V

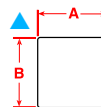

BOTTLE TAMPER SEAL LABELS

Diagram	Order Reference	Label Width A (mm)	Label Height B (mm)	Labels/ Package	BP1344 Model Ribbon	BP Precision™ 200/300MVP 600X-II Ribbon	Special Properties
	THT-5-351-10	25.40	12.70	10,000	R-6201	R-6202	F P G
	THT-17-351-3	50.80	25.40	3,000	R-6201	R-6200	F P G